



# Seehafer Shoreline Restoration



**Project:** Shoreline stabilization and restoration on 100 feet of shoreline. The project included repair of eroded areas, soil amendments, slope stabilization, and planting of native aquatic, transitional, and upland plants and shrubs.

**Funding:** Dakota County SWCD provided technical assistance and Conservation Cost Share funding in the amount of \$1,468.36

**Costs:** The materials and plant costs for the project were \$2,936.71.



## Location:

Burnsville  
Minnesota

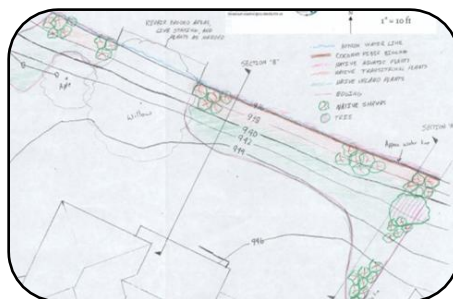

**Practice:**  
Shoreline Restoration

**Benefits:**

Reduction of erosion

Filtration of stormwater runoff prior to discharge to the waterbody

Improves aquatic and wildlife habitat

Improves aesthetics

Increases watershed stewardship

Opportunity for public education and outreach

**Partners:**

Blue Thumb

**Watershed:**

Minnesota River

**Construction:**

July  
2008



# Seehafer Shoreline Restoration

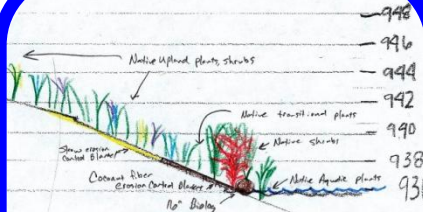

Cross-section of planting area



Herbicide treatment of existing turf grass and weeds



Repair of eroded areas and soil amendments



Installation of erosion control blanket and coconut fiber biologs



Bank after installation of erosion control materials



Installation of native aquatic, transitional, and upland plants and shrubs



Planted shoreline with temporary goose protection fence



View of planted project looking east immediately after planting



Restored shoreline 2 months after planting